

# REVOLUTION TEA MINI DISPENSER

## *System Requirements*

### **Plumbing Requirements**

Revolution Tea dispensers must be connected to a cold water system with operating pressure between 30 and 90 PSI. from a ½ supply line. Each dispensing unit requires a ½ Ball Valve style cut-off to be located within 10 feet.

### **Water Source**

Water source is critically important to the operation of the dispenser. A filtered water source or in-line water filter is necessary to protect the clean fresh taste of Revolution Premium Iced Teas. Recommendation for a water filter is Everpure 4C it is rated for 3000 gallons.



### **Installation of the Mini Dispenser**

#### **Step 1**

Connect a John Guest Male Connector -3/8 x 1/2 NPTF to the ½ ball valve.



#### **Step 2**

Remove dispenser from box and attach 10 foot long white 3/8" OD tubing (from box) to ball valve and flush 2 gallons of water through waterline to remove any foreign particles that might be in the line.



#### **Step 3**

After flushing is completed, connect 3/8" beverage tubing to John Guest 3/8" plastic fitting on the back of the Dispenser.



**Step 4**

Remove the Tea Pouch from carton and then safety cap from tea pouch.



**Step 5**

Connect Scholle Connector to tea pouch fitting. While keeping pouch upright, dispense a small amount of tea.



**Step 6**

Turn connected tea pouch upside down.



**Step 7**

Gently insert pouch into dispenser.

The built-in water pressure regulator is factory tested and set for a static pressure of 22 PSI. Don't make any pressure regulator adjustments on dispenser (Do NOT attempt to adjust the regulator. If a regulator adjustment is required call Revolution Tea).

Review dispenser operation and training with all staff and management at these locations: Loading Tea, Flush/Sanitizing, Maintaining Dispenser (including faucet/seat cup cleaning) and Taste Test.

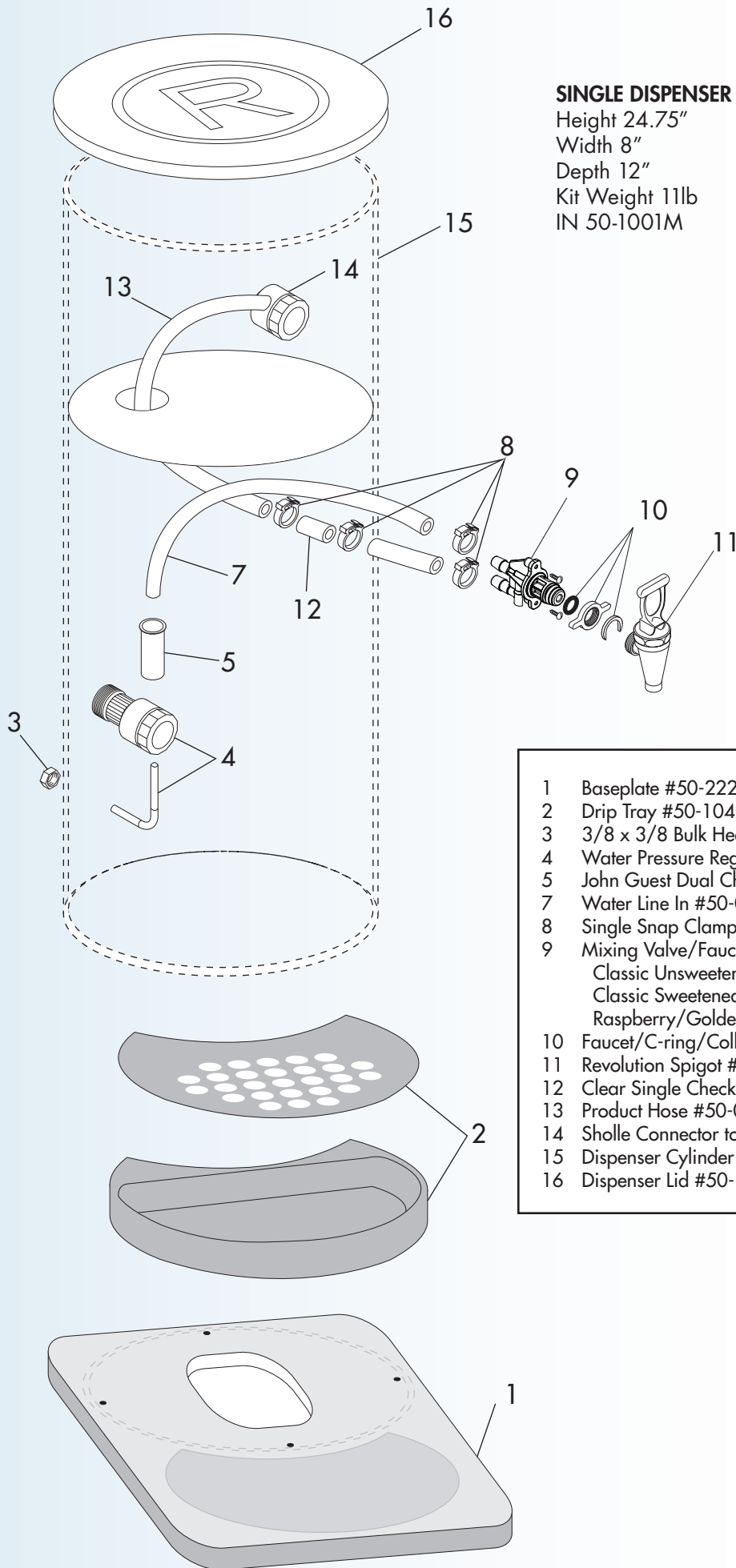

**SINGLE DISPENSER KIT**

Height 24.75"  
 Width 8"  
 Depth 12"  
 Kit Weight 11lb  
 IN 50-1001M

**DOUBLE DISPENSER KIT**

Height 24.75"  
 Width 16"  
 Depth 12"  
 Kit Weight 28lb  
 IN 50-1001MD

- 1 Baseplate #50-2222 (Dual) #50-2223 (Single)
- 2 Drip Tray #50-1042
- 3 3/8 x 3/8 Bulk Head Union #50-0075
- 4 Water Pressure Regulator #50-0088
- 5 John Guest Dual Check Valve #50-0055
- 7 Water Line In #50-0112
- 8 Single Snap Clamp #50-0110
- 9 Mixing Valve/Faucet Shank  
 Classic Unsweetened #50-0098CU  
 Classic Sweetened #50-0098CS  
 Raspberry/Golden Peach #50-0098RP
- 10 Faucet/C-ring/Collar #50-0068
- 11 Revolution Spigot #50-0068
- 12 Clear Single Check Valve #50-0124
- 13 Product Hose #50-0111
- 14 Sholle Connector to BIB #50-0009
- 15 Dispenser Cylinder #50-1035
- 16 Dispenser Lid #50-1043